

**PLANT SCHEDULE**

KEY	QTY	BOTANICAL NAME	COMMON NAME	SIZE	ROOT	REMARKS
<b>TREES</b>						
GT	3	GLEDITSIA TRIACANTHOS INERMIS 'SKYLINE'	SKYLINE HONEYLOCUST	3" CALIPER	B&B	FULL AND EXTRA HEAVY; MATCHING
MA	2	AMELANCHIER CANADENSIS	SHADBUSH	2-1/2"-3" CAL	B&B	FULL AND EXTRA HEAVY; MATCHING
<b>SHRUBS</b>						
AB	6	RHODODENDRON PERICLYMENOIDES	PINXTERBLOOM AZALEA	15"-18" HT.	CONT	FULL AND EXTRA HEAVY; MATCHING
AD	7	RHODODENDRON ARBORESCENS	SWEET AZALEA	15"-18" HT.	CONT	FULL AND EXTRA HEAVY; MATCHING
CA	5	CLETHRA ALNIFOLIA 'HUMMINGBIRD'	HUMMINGBIRD SUMMERSWEET	24"-30" HT.	B&B	FULL AND EXTRA HEAVY; MATCHING
IC	17	ILEX CRENATA 'SOFT TOUCH'	SOFT TOUCH COMPACT HOLLY	15"-18" HT.	CONT	FULL AND EXTRA HEAVY; MATCHING
IG	9	ILEX GLABRA COMPACTA	COMPACT INKBERRY	18"-24" HT.	B&B	FULL AND EXTRA HEAVY; MATCHING
JC	14	JUNIPERUS CHINENSIS 'ROBUSTA GREEN'	ROBUSTA GREEN JUNIPER	36"-42" HT.	B&B	FULL AND EXTRA HEAVY; MATCHING
JS1	6	JUNIPERUS SCOPULORUM 'SKYROCKET'	SKYROCKET JUNIPER	36"-42" HT.	B&B	FULL AND EXTRA HEAVY; MATCHING
JS2	9	JUNIPERUS SCOPULORUM 'MEDORA'	MEDORA JUNIPER	36"-42" HT.	B&B	FULL AND EXTRA HEAVY; MATCHING
RC	7	RHODODENDRON CATAWBIENSE 'CHIONOIDES'	CHIONOIDES RHODODENDRON	18"-24" HT.	CONT	FULL AND EXTRA HEAVY; MATCHING
RP	6	RHODODENDRON PJM 'COMPACTA'	COMPACT PJM RHODODENDRON	18"-24" HT.	CONT	FULL AND EXTRA HEAVY; MATCHING
<b>GROUND COVER</b>						
EF	420	EUONYMUS FORTUNEI 'COLORATUS'	PURPLELEAF WINTER CREEPER	3" POT	CONT	MIN. (3) 10" RUNNERS PER POT @ 12" O.C.
JH	71	JUNIPERUS HORIZONTALIS 'BAR HARBOR'	BAR HARBOR JUNIPER	18" SPREAD	CONT	FULL AND EXTRA HEAVY @ 30" O.C.
VM	290	VINCA MINOR 'BOWLES'	MYRTLE	4" POT	CONT	MIN. (3) 10" RUNNERS PER POT @ 12" O.C.

**PLANTING NOTES**

- ALL PLANT MATERIAL MUST CONFORM TO THE REQUIREMENTS OF THE PLANTING SCHEDULE AND STANDARDS OF THE AMERICAN ASSOCIATION OF NURSERYMEN.
- ALL PLANT MATERIAL MUST BE APPROVED AT THE NURSERY SOURCE BY THE OWNER'S REPRESENTATIVE PRIOR TO INSTALLATION.
- PROTECT ALL EXISTING VEGETATION ADJACENT TO CONSTRUCTION OPERATIONS. CARE SHOULD BE TAKEN TO ENSURE THAT SOIL CONTAINING TREE ROOTS IS NOT COMPACTED.
- ALL SITE CONSTRUCTION OPERATIONS TO COMPLY WITH ANY AND ALL LOCAL, STATE AND FEDERAL REGULATORY REQUIREMENTS.

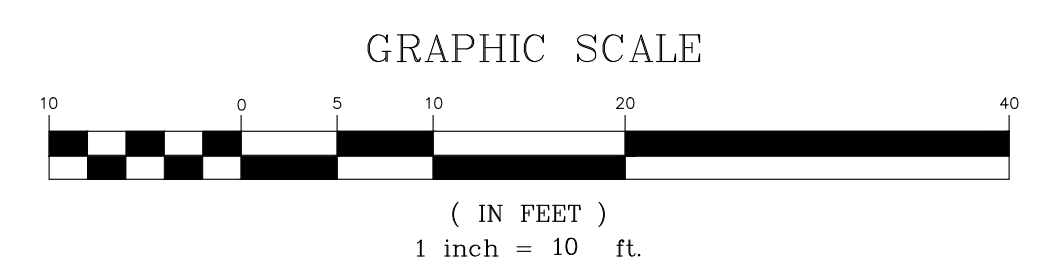
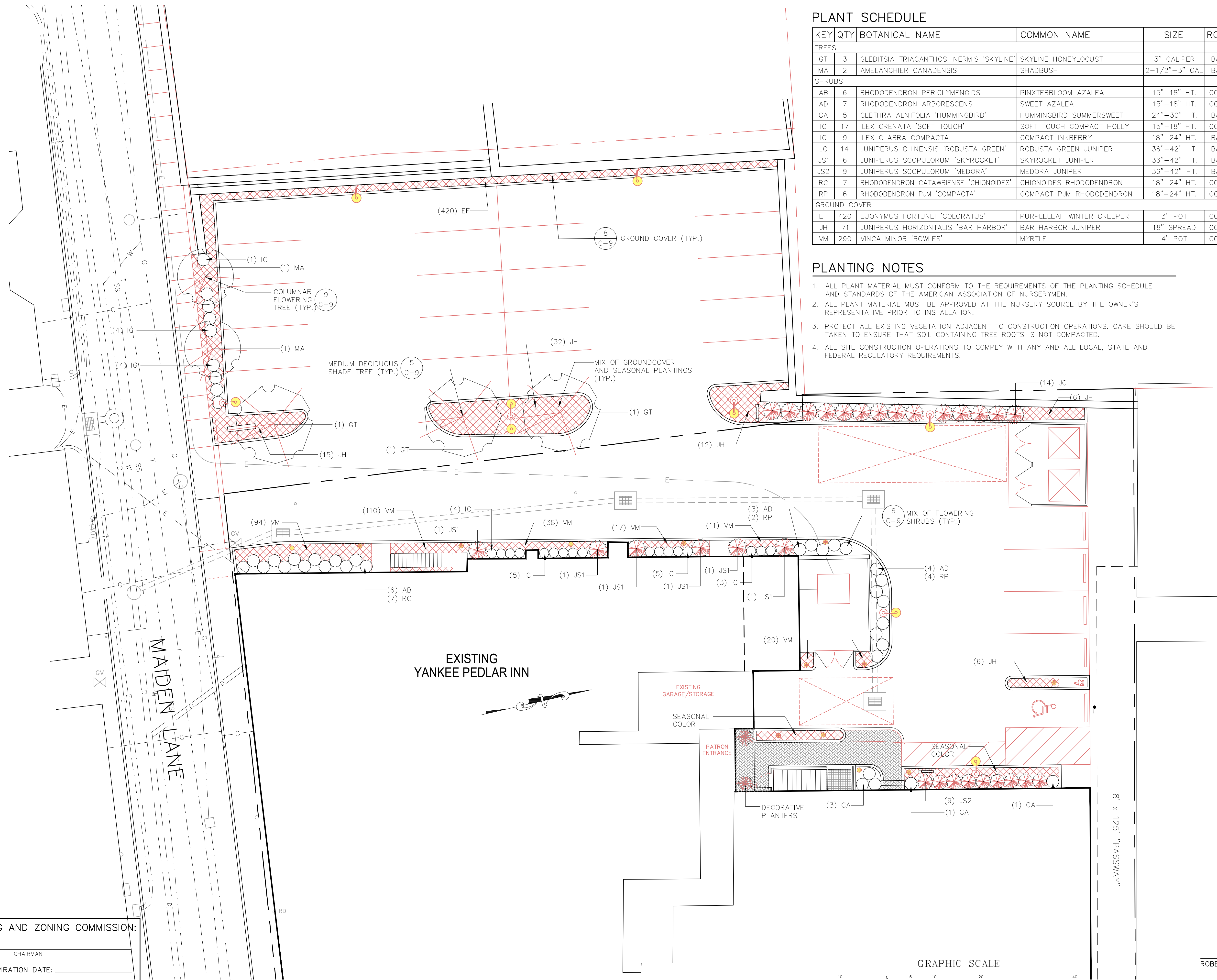

ROBERT GILCHREST, LANDSCAPE GARDENER

APPROVED BY PLANNING AND ZONING COMMISSION:

1. FINAL APPROVAL: \_\_\_\_\_ CHAIRMAN  
 DATE: \_\_\_\_\_ EXPIRATION DATE: \_\_\_\_\_  
 2. CONDITIONAL APPROVAL: \_\_\_\_\_ CHAIRMAN  
 DATE: \_\_\_\_\_ EXPIRATION DATE: \_\_\_\_\_