

SEA

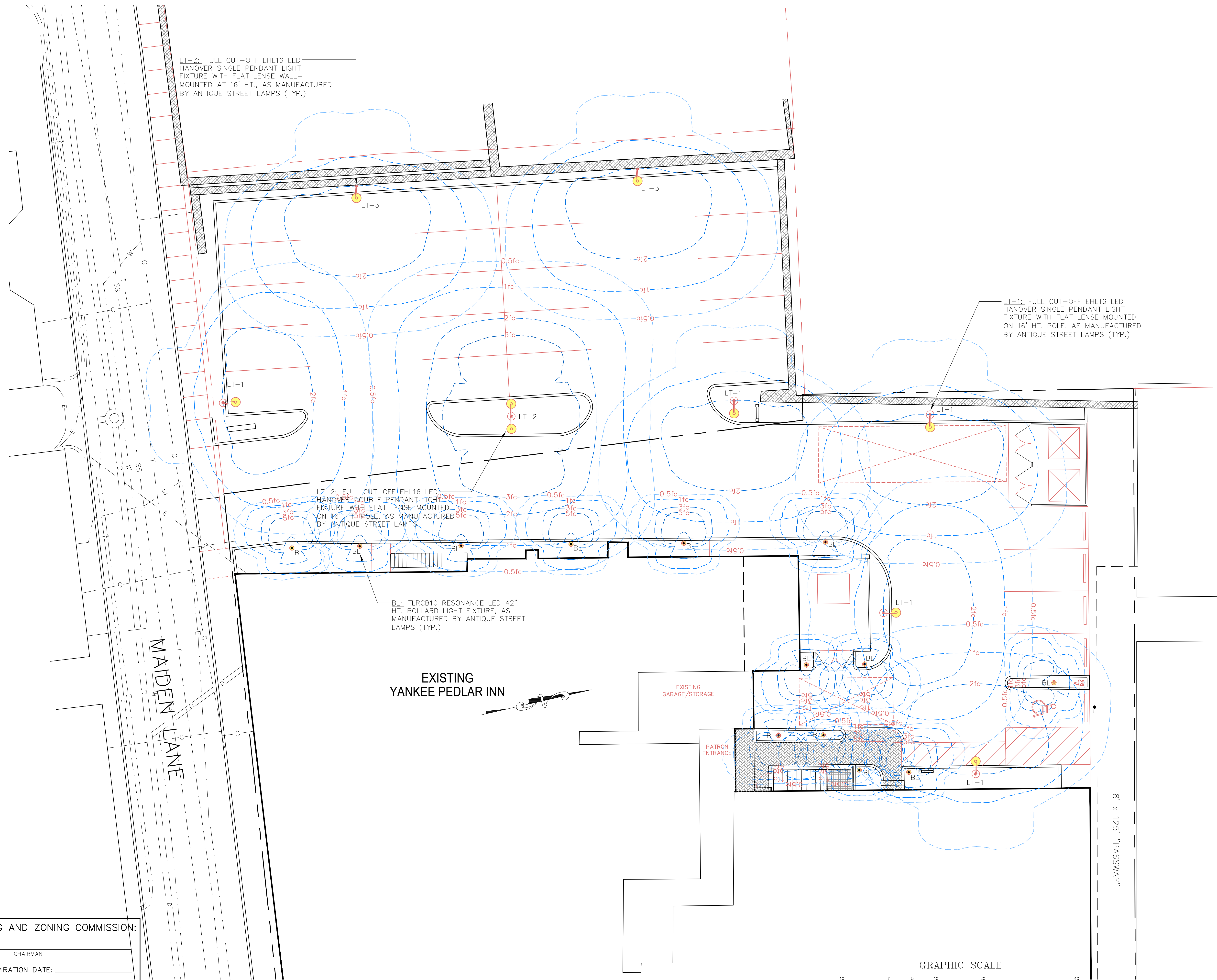

LT-3: FULL CUT-OFF EHL16 LED HANOVER SINGLE PENDANT LIGHT FIXTURE WITH FLAT LENSE WALL-MOUNTED AT 16" HT., AS MANUFACTURED BY ANTIQUE STREET LAMPS (TYP.)

LT-1: FULL CUT-OFF EHL16 LED HANOVER SINGLE PENDANT LIGHT FIXTURE WITH FLAT LENSE MOUNTED ON 16" HT. POLE, AS MANUFACTURED BY ANTIQUE STREET LAMPS (TYP.)

LT-2: FULL CUT-OFF EHL16 LED HANOVER DOUBLE PENDANT LIGHT FIXTURE WITH FLAT LENSE MOUNTED ON 16" HT. POLE, AS MANUFACTURED BY ANTIQUE STREET LAMPS

BL: TLRCB10 RESONANCE LED 42" HT. BOLLARD LIGHT FIXTURE, AS MANUFACTURED BY ANTIQUE STREET LAMPS (TYP.)

EXISTING YANKEE PEDLAR INN

EXISTING GARAGE/STORAGE

PATRON ENTRANCE

8' x 125' "PASSWAY"

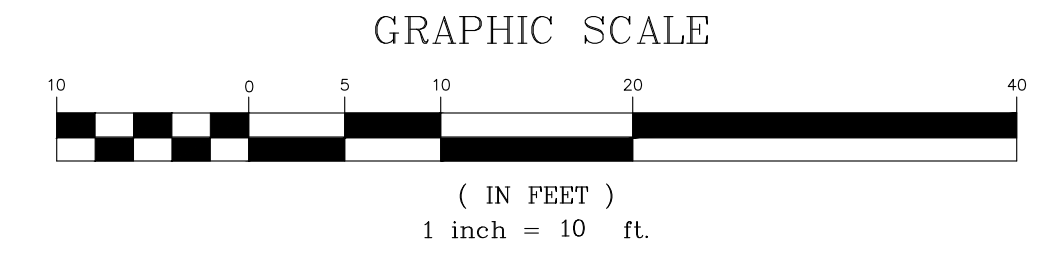

APPROVED BY PLANNING AND ZONING COMMISSION:

1. FINAL APPROVAL: \_\_\_\_\_ CHAIRMAN  
 DATE: \_\_\_\_\_ EXPIRATION DATE: \_\_\_\_\_

2. CONDITIONAL APPROVAL: \_\_\_\_\_ CHAIRMAN  
 DATE: \_\_\_\_\_ EXPIRATION DATE: \_\_\_\_\_