

CONIFEROUS TREE DETAIL
 N.T.S.

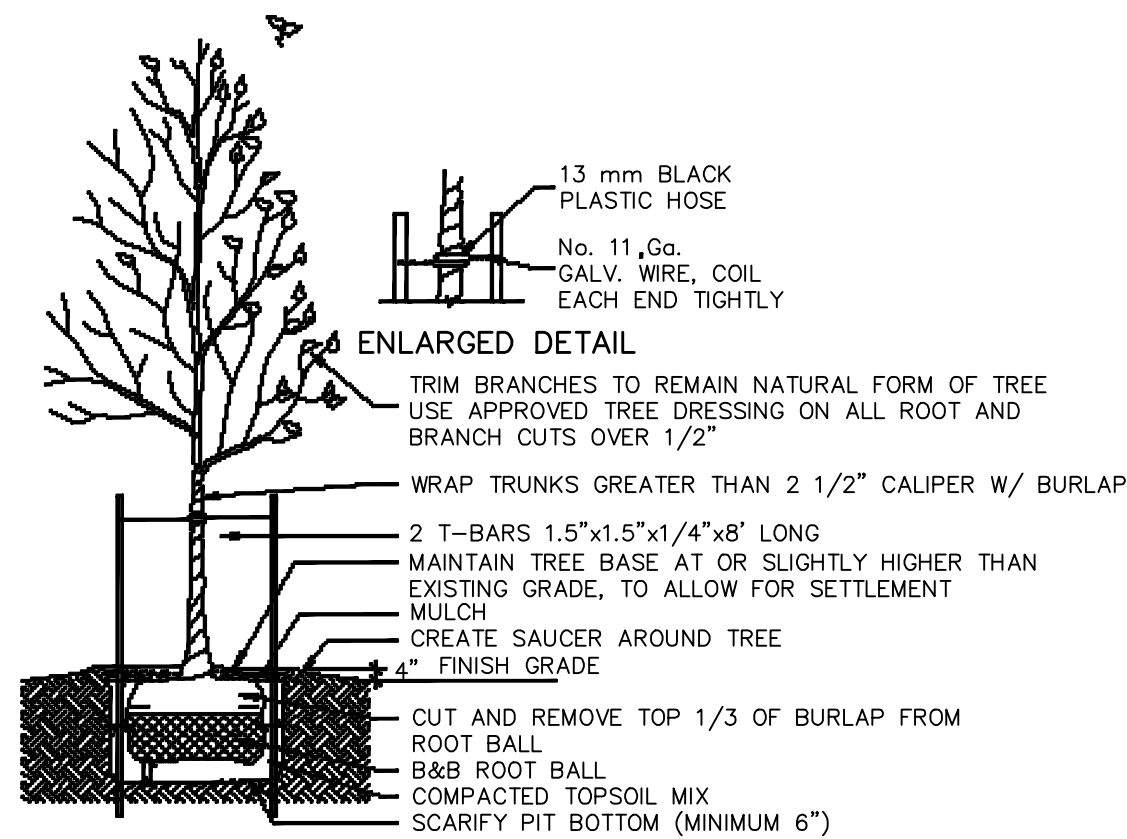

DECIDUOUS TREE DETAIL
 N.T.S.

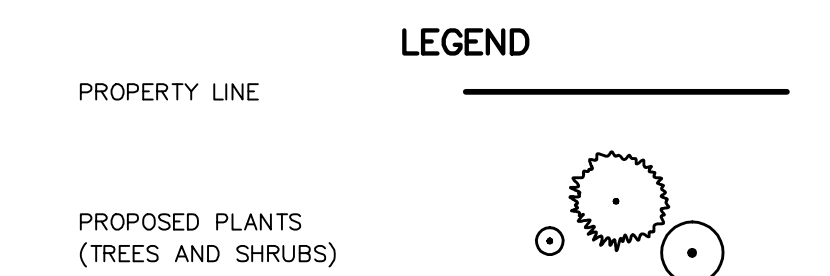
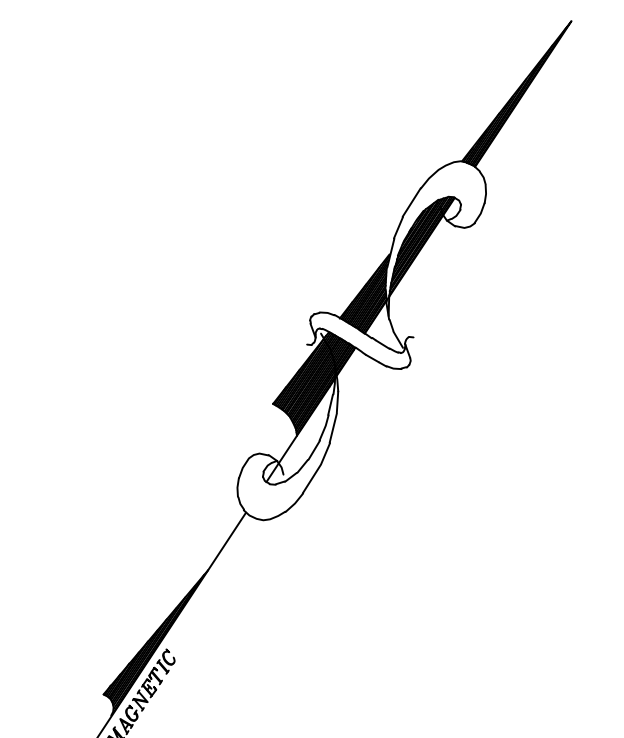
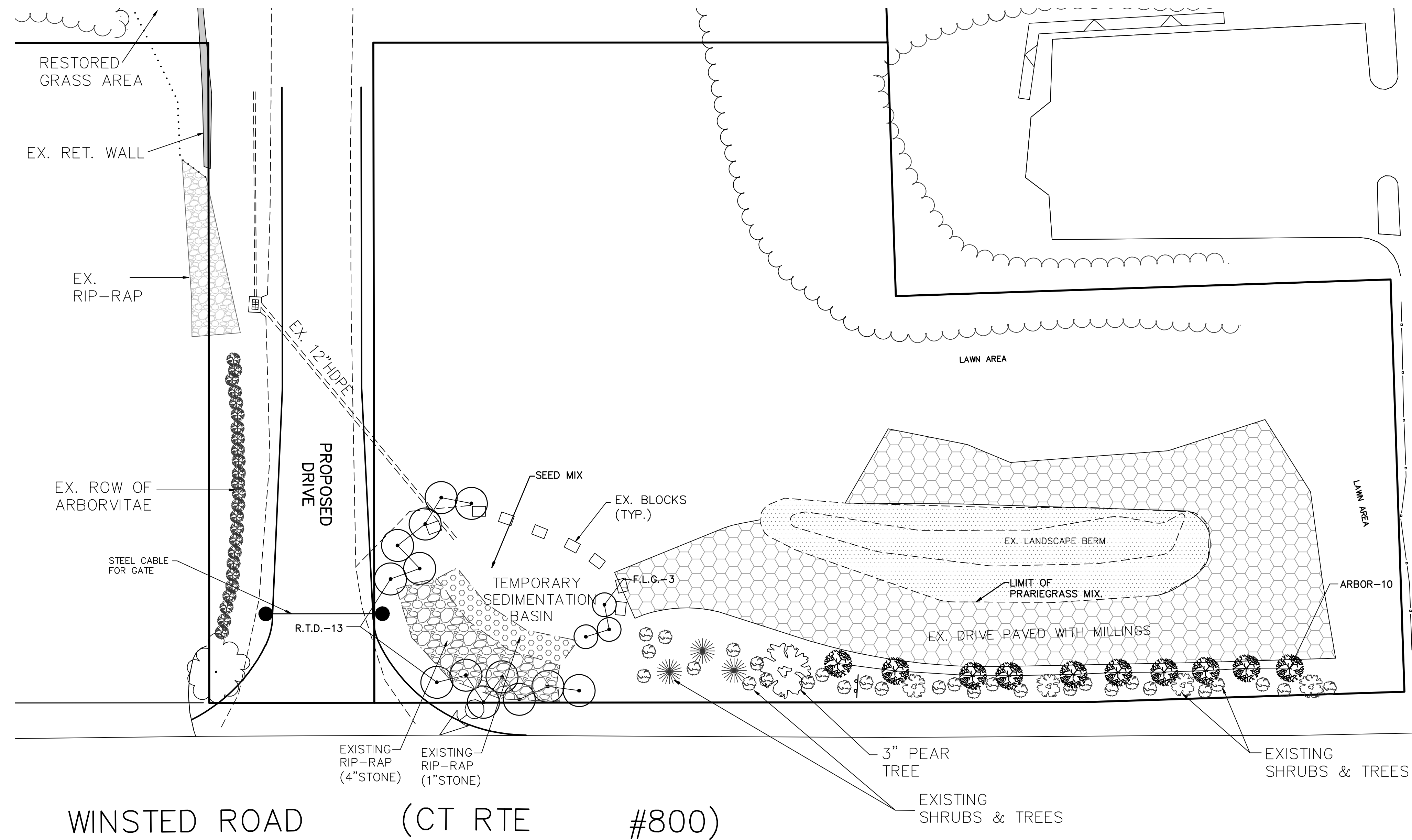

SOUTH FARMS NURSERY, INC.
 P.O. BOX 338 / ROUTE 63 SOUTH
 GOSHEN, CT. 06756

PLANTING LEGEND

KEY	QTY	BOTANICAL NAME	COMMON NAME	SIZE
MS	5	MALUS SNOWDRIFT	SNOWDRIFT CRABAPPLE	2.5 / 3" CAL
PS	4	PINUS STROBUS	WHITE PINE	6 / 8'
FLG	26	FORSYTHIA LYNWOOD GOLD	LYNWOOD GOLD FORSYTHIA	2 GAL
RTD	13	CORNUS ALBA SERICEA	RED TWIG DOGWOOD	2 GAL
ARBOR	10	THUJA PLICATA	GREEN GIANT ARBORVITAE	5-6' HIGH

LAWN AREA SEED
 33% SHAMROCK KENTUCKY BLUEGRASS
 33% SHADEMARK RED FESCUE
 34% PROSPORT PERENNIAL RYEGRASS

PRARIEGRASS MIX
 25% BIG BLUESTEM
 10% BLUE GAMMA
 10% INDIANGRASS
 25% LITTLE BLUESTEM
 10% SIDEGATS GAMMA
 5% SWITCHGRASS
 10% VIRGINIA WILDRYE
 2% BLACK-EYE SUSAN
 3% OX-EYE DAISY

NO LIGHTING PROPOSED.

REVISED 12-27-19 ADDITIONAL GREEN GIANT ARBORVITAE ALONG WINSTED ROAD.

RESTORATION & LANDSCAPING PLAN
 PREPARED FOR
AJK, LLC
 659 WINSTED ROAD
 CT RTE. #800
 TORRINGTON, CONNECTICUT

SOUTH FARMS NURSERY INC.
 513 WEST MORRIS ROAD
 MORRIS, CT 06763
 DESIGN BY: John LaPlaca

Date: 11/06/21	Proj. No.: 01-459-SP-202(L2)	Sheet: L2
Scale: 1"=20'	Drawn By: MS	Map No.: 459