

- PROPERTY LINE
- EXISTING MONUMENT
- EXISTING IRON PIN OR PIPE
- PROPOSED IRON PIN OR PIPE
- PROPOSED MONUMENT
- UTILITY POLE W/ANCHOR
- CATCH BASIN
- LIGHT POLE
- EXISTING CONTOUR
- EXISTING SPOT ELEVATION
- PROPOSED CONTOUR
- PROPOSED SPOT ELEVATION
- FLAGGED WETLANDS
- GUIDE RAIL

Plant List for Bank Building

amount	size	Trees	Shrubs	Grasses and Perennials
13	b&b 10-12 ft clumping	Betula nigra "Dura Heat"	Ilex glabra "Shamrock"	Coreopsis verticillata
10	b&b 8-10ft	Cercis canadensis	Morella carolinensis	Schizachyrium scoparium
4	b&b 8-10ft	Nyssa sylvatica	Potentilla fruticosa	Sporobolus heterolepis
			Rhus aromatica	Tridens flavus
			Rhus aromatica "Low Gro"	
			Rosa carolina	
44	2 qt			
100	1gal			
31	1gal			
10	1gal			

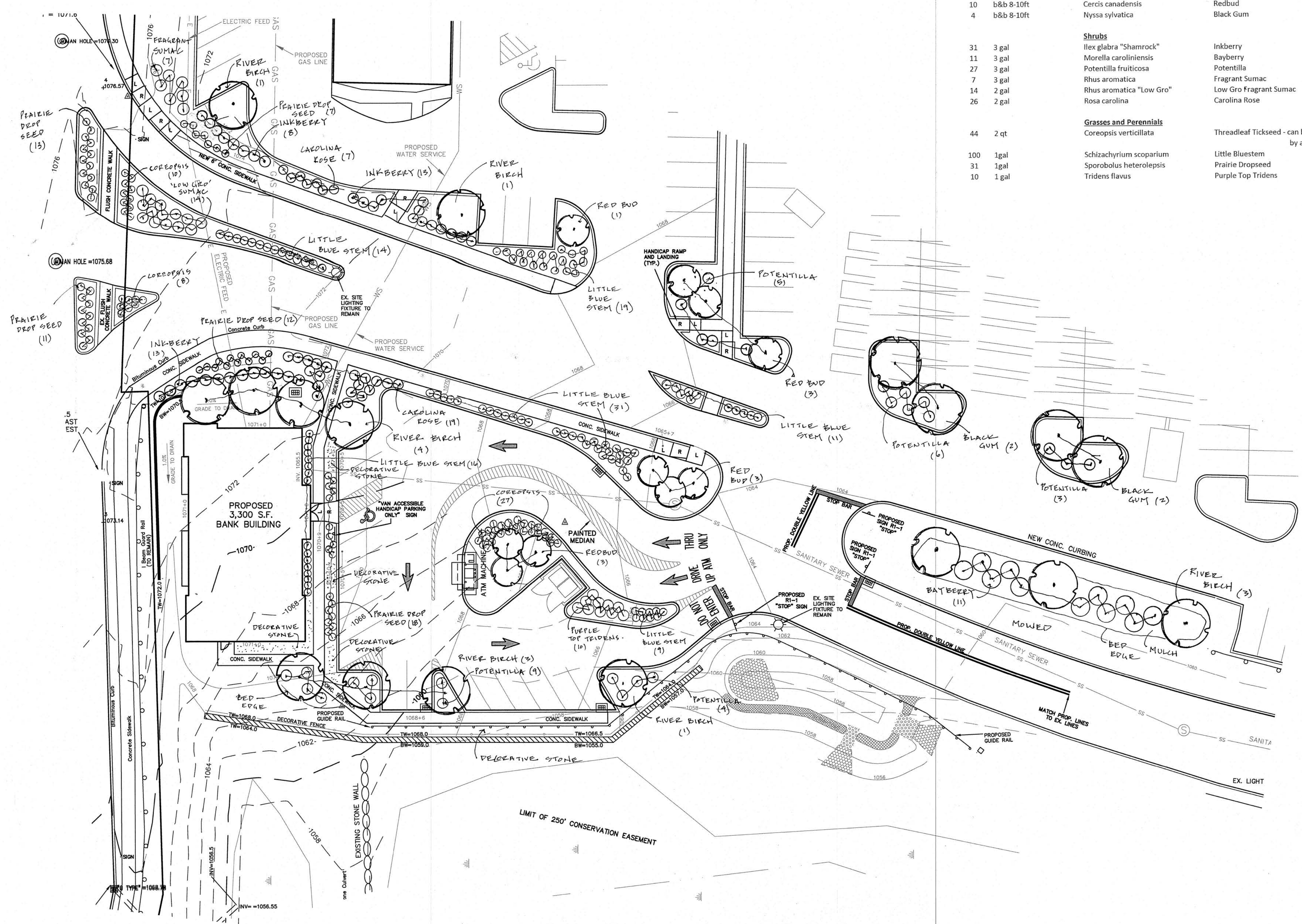

PROPOSED 3,300 S.F.
PAD SITE

LANDSCAPE DESIGN
BY
EARTH TONES LLC
WOODBURY, CT
203.263.6626
EARTHTONENATIVES.COM
DATE DRAWN: 9.24.2023.

08/30/23	NEW SITE LAYOUT
DATE	REVISION
LANDSCAPE PLAN	
PREPARED FOR TORRINGTON FAIR SHOPPING PLAZA EAST MAIN STREET (ROUTE 202) TORRINGTON, CONNECTICUT	
Hrica Associates LLC	
<small>Kenneth S. Hrica, PE, RLS 44 Maple View Trail P.O. Box 1981 Litchfield, Connecticut 06759</small>	
<small>860-587-2112 (business) 860-587-5491 (residential) e-mail: hricassociates@optonline.net</small>	
DATE: 08/21/2020	MAP #: 0099
SCALE: 1"=20 ft.	SHEET #: C14
DRAWING: 140501	DRAWN BY: ALL
PROJECT #: 14-0501	CHECKED BY: KSH

NOT VALID WITHOUT ORIGINAL SEAL.