

CONNECTICUT GRID (MAP REF.)

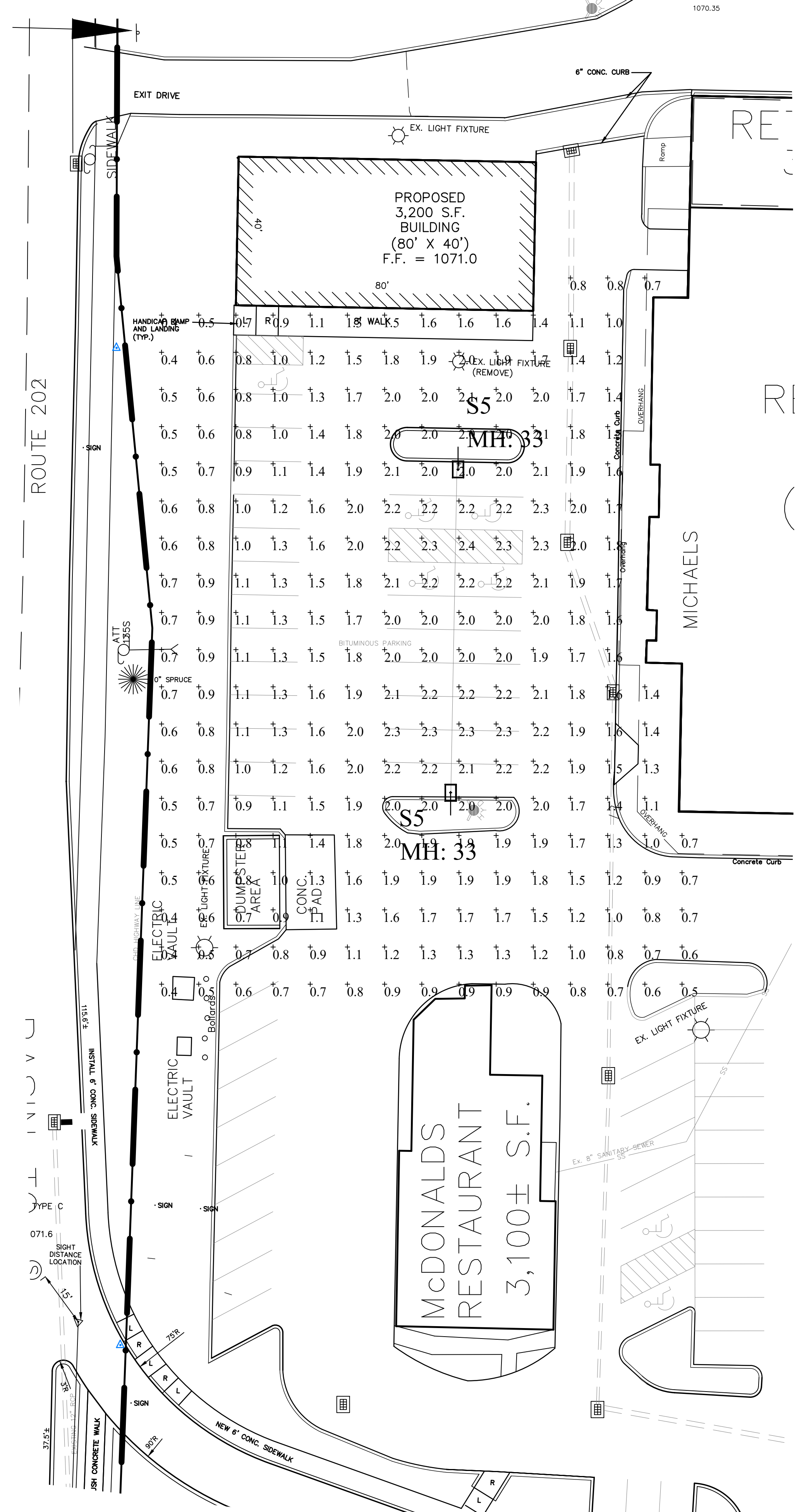

PROPOSED 2500 SQ.FT. BUILDING

Torrington Fair Plaza Site Lighting

Symbol	Qty	Label	Arrangement	Lum. Lumens	Lum. Watts	LLF	BUG Rating	Description
S2	183	SINGLE	2400	183	1900	0.90	B3-U0-44	Lithonia DSX2 LED P2 40K T4M MVOLT SPA PER SXC(FINISH) - SSS 30 5G DM19AS SXC(FINISH) 30FT POLE on 3FT BASE
S4	2766	SINGLE	2766	217	0.900	B3-U0-44	Lithonia DSX2 LED P2 40K T4M MVOLT SPA PER SXC(FINISH) - SSS 30 5G DM19AS SXC(FINISH) 30FT POLE on 3FT BASE	
S5	2931	SINGLE	2931	217	0.900	B3-U0-43	Lithonia DSX2 LED P2 40K T4M MVOLT SPA PER SXC(FINISH) - SSS 30 5G DM19AS SXC(FINISH) 30FT POLE on 3FT BASE	
S4	2824	SINGLE	2824	179	0.900	B3-U0-45	Lithonia DSX2 LED P2 40K T4M MVOLT SPA PER SXC(FINISH) - SSS 30 5G DM19AS SXC(FINISH) 30FT POLE on 3FT BASE	

Label	Calc Type	Units	Avg	Max	Min	Avg/Min	Max/Min
NE PROPOSED BLDG PARKING	Illuminance	Fc	1.41	2.4	0.4	3.53	6.00
SE ENTER CORSET	Illuminance	Fc	1.36	2.8	0.2	14.00	14.00
CHASE BANK PAD SITE	Illuminance	Fc	1.43	3.5	0.0	N.A.	N.A.
CHASE BANK ENTRY DRIVEWAYS	Illuminance	Fc	2.54	3.3	1.6	1.99	2.06
CHASE BANK PARKING	Illuminance	Fc	2.82	3.3	1.7	1.66	1.94

Greg Loda
Lighting Affiliates
1208 Cornwall Ave
Rocky Hill, CT 06067
www.lightingaffiliates.com
Voice Number: (860) 721-1171 x 219
Email Address: gloda@lightingaffiliates.com

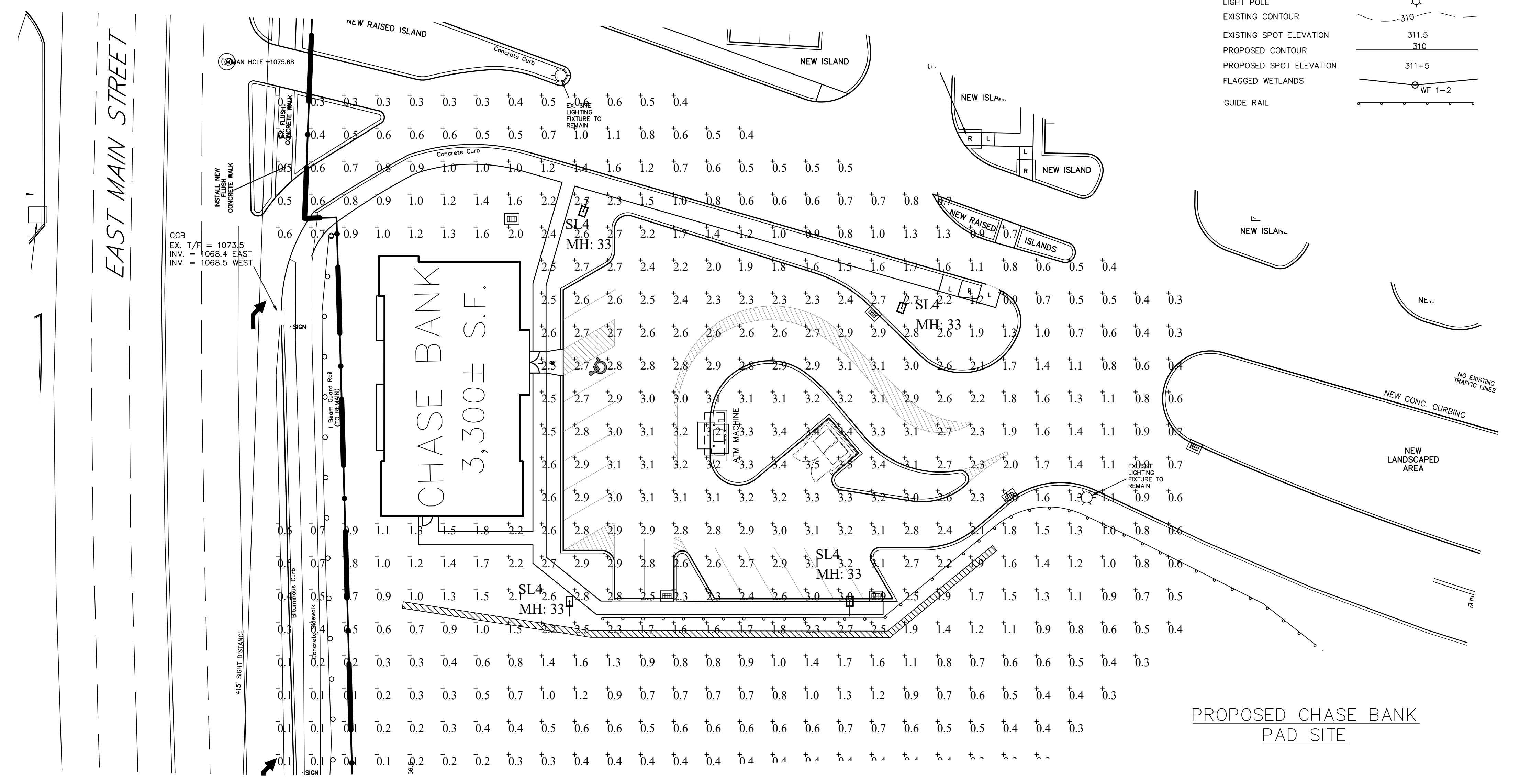

PROPOSED CHASE BANK PAD SITE

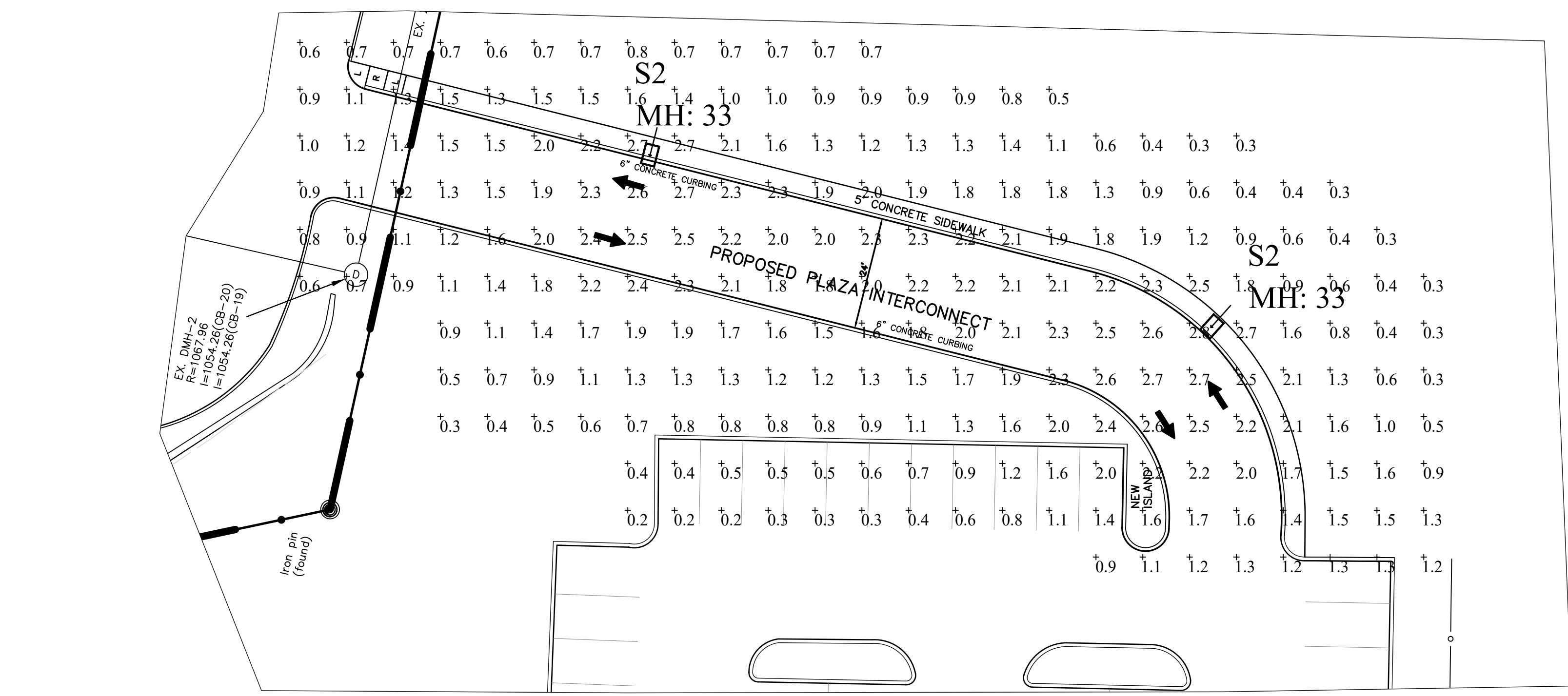

PROPOSED INTERCONNECT

LEGEND

- PROPERTY LINE
- EXISTING MONUMENT
- EXISTING IRON PIN OR PIPE
- PROPOSED IRON PIN OR PIPE
- PROPOSED MONUMENT
- UTILITY POLE W/ANCHOR
- CATCH BASIN
- LIGHT POLE
- EXISTING CONTOUR
- EXISTING SPOT ELEVATION
- PROPOSED CONTOUR
- PROPOSED SPOT ELEVATION
- FLAGGED WETLANDS
- GUIDE RAIL

09/20/23 CHASE BANK PAD
DATE REVISION

LIGHTING PLAN
PREPARED FOR
TORRINGTON FAIR SHOPPING PLAZA
EAST MAIN STREET (ROUTE 202)
TORRINGTON, CONNECTICUT

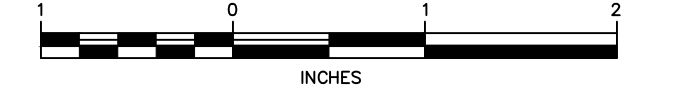

Hrica Associates LLC
Engineers Surveyors
Kenneth S. Hrica, P.E., R.S.
44 Maple View Trail
P.O. Box 1981
Litchfield, Connecticut 06759
860-567-2112 (business)
860-567-0491 (fax)
e-mail: hricaassociates@optonline.net

DATE: 09/21/2020 MAP #: 0099
SCALE: 1"=20 ft. SHEET #: C19
DRAWING: 140501 DRAWN BY: ALL
PROJECT #: 14-0501 CHECKED BY: KSH

NOT VALID WITHOUT ORIGINAL SEAL