

ENGINEERING NOTES

1. TOPOGRAPHIC INFORMATION BASED ON SITE SURVEY PLAN COMPLETED BY DAVID LITTLE, L.L.S. A FIELD BENCHMARK HAS BEEN PROVIDED (NAIL IN 20" MAPLE). ELEVATIONS TO BE FIELD VERIFIED PRIOR TO INITIATING CONSTRUCTION.
2. UTILIZE SILT FENCE/HAYBALES AS NEEDED TO PREVENT SEDIMENT RUNOFF DURING ALL PHASES OF CONSTRUCTION.
3. NOTIFY ENGINEER (860-601-1839) OF ANY CHANGES OR CONDITIONS, WHICH AFFECT THE INSTALLATION AS SHOWN ON THIS PLAN.

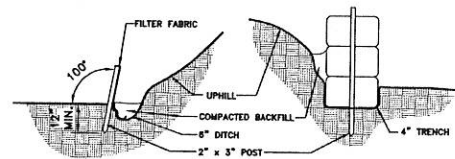

SOIL EROSION CONTROL PROVISIONS  
SCALE: NONE

J ROAD - CONNECTICUT

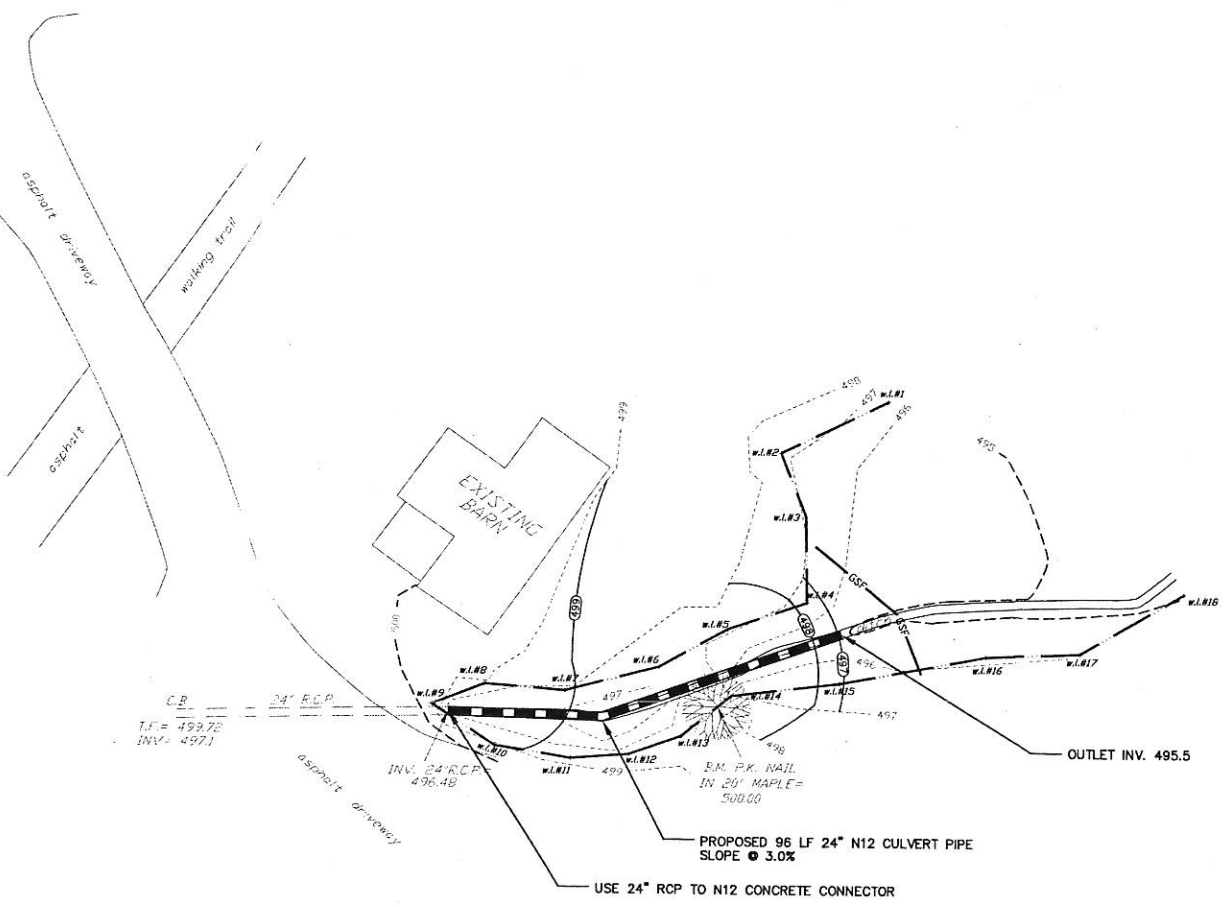

**CEC** Colby Engineering And Consulting, LLC  
4 BRYNMOOR COURT  
GOSHEN, CONNECTICUT 06756  
(860) 491-9664

|                   |
|-------------------|
| DES'D BY : WGC    |
| APP'D BY : WGC    |
| DRAWN BY : DRAWER |
| SCALE : 1"=20'    |
| DATE : DATE       |
| REVISION DATE :   |



VALID WITH RED SEAL ONLY  
*William G. Colby*  
WILLIAM G. COLBY

**DRAINAGE IMPROVEMENT PLAN**  
**FRAGALE AND SONS**  
**PAVING CONTRACTORS, INC.**  
**2904 WINSTED ROAD**  
**TORRINGTON, CONNECTICUT**

PROJECT:  
#  
SHEET 1