

# PROPOSED WETLAND MITIGATION PLAN

By: REMA Ecological Services, LLC

Date: 10/23/2023 (revised)

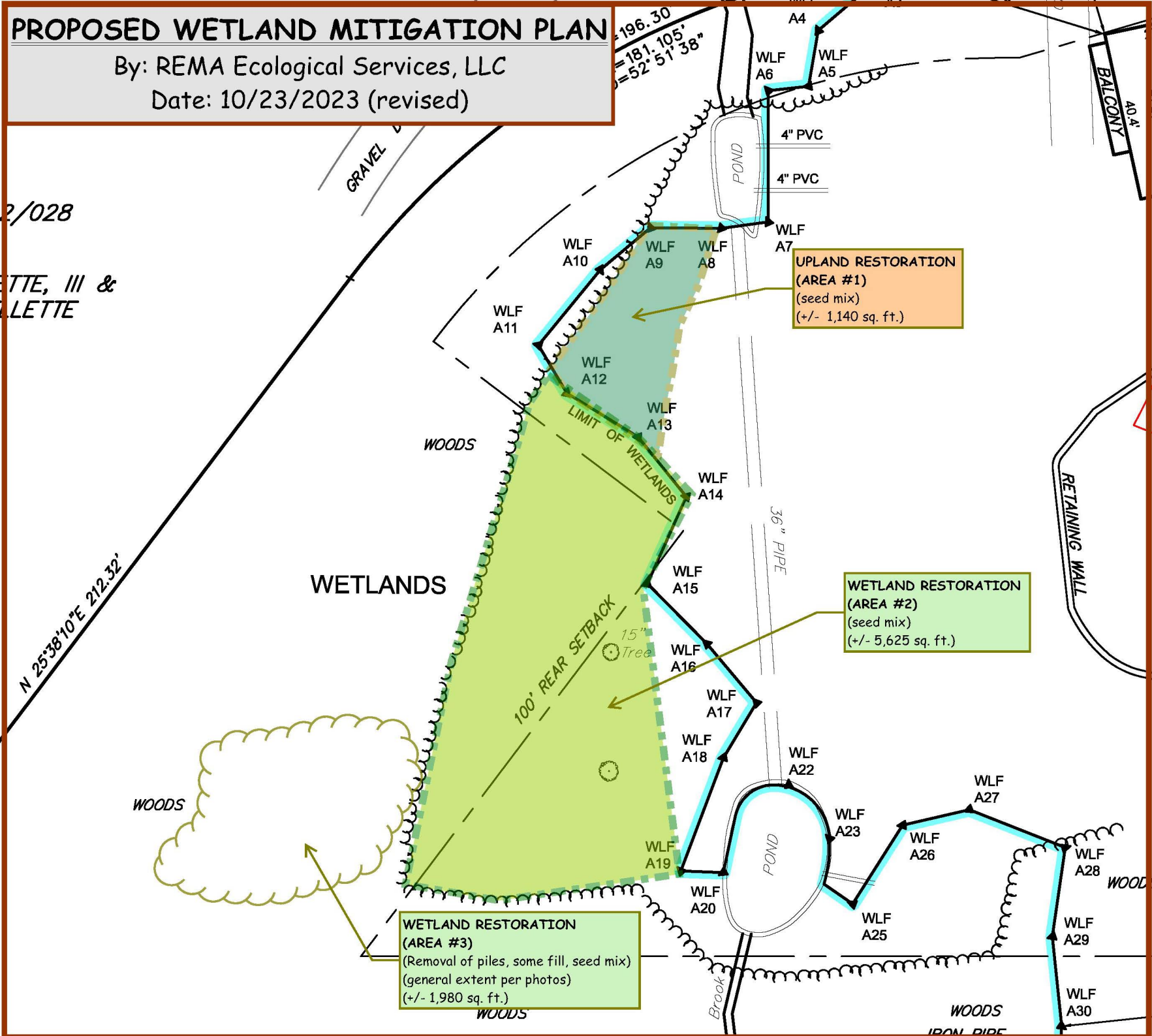

## MITIGATION IMPLEMENTATION NOTES:

1. The New England Roadside Matrix Upland Seed Mix shall be used for upland restoration.
2. The New England Roadside Matrix Wet Meadow Seed Mix shall be used for wetland restoration
3. Prior to seeding the planting medium in Areas #1 and #2, shall be prepared by tilling the lawn areas to a depth of 6 to 8 inches (e.g., rototilling)
4. The planting bed shall be fertilized (e.g., Milorgonite) and pH adjusted to 6.8 - 7.2 by liming.
5. Seed shall be applied with a nurse crop, at 10% by weight, such annual ryegrass.
6. The seeded areas shall be watered and covered with a thin layer of weed free straw.
7. In the late fall seeding can take place after the first hard frost or in mid- to late April.
8. Inspection/Monitoring shall take place for two years after implementation with memo to Town staff.
9. Removal of invasive plants shall take place during the 2-year monitoring period.

# **NEW ENGLAND WETLAND PLANTS, INC**

820 WEST STREET, AMHERST, MA 01002

PHONE: 413-548-8000 FAX 413-549-4000

EMAIL: INFO@NEWP.COM WEB ADDRESS: WWW.NEWP.COM

## **New England Roadside Matrix Upland Seed Mix**

<b>Botanical Name</b>	<b>Common Name</b>	<b>Indicator</b>
<i>Elymus virginicus</i>	Virginia Wild Rye	FACW-
<i>Desmodium paniculatum</i>	Panicleleaf Tick Trefoil	
<i>Schizachyrium scoparium</i>	Little Bluestem	FACU
<i>Andropogon gerardii</i>	Big Bluestem	FAC
<i>Festuca rubra</i>	Red Fescue	FACU
<i>Sorghastrum nutans</i>	Indian Grass	UPL
<i>Panicum virgatum</i>	Switch Grass	FAC
<i>Rhus typhina</i>	Staghorn Sumac	
<i>Cornus racemosa</i>	Grey Dogwood	FAC
<i>Cornus amomum</i>	Silky Dogwood	FACW
<i>Oenothera biennis</i>	Evening Primrose	FACU-
<i>Asclepias tuberosa</i>	Butterfly Milkweed	NI
<i>Rudbeckia hirta</i>	Black Eyed Susan	FACU-
<i>Chamaecrista fasciculata</i>	Partridge Pea	FACU
<i>Eupatorium fistulosum (Eutrochium fistulosum)</i>	Hollow-Stem Joe Pye Weed	FACW

PRICE PER LB. \$69.00 MIN. QUANTITY 1 LBS. **TOTAL:** \$69.00 APPLY: 35 LBS/ACRE :1250 sq ft/lb

The New England Roadside Matrix Mixes are designed for use along roads and highways. These mixes are unusual in that they contain native grasses, wildflowers, and shrubs that are blended together as a native matrix seed mix. In areas that receive frequent mowing, the cold season grasses will dominate, such as those areas closest to the roadway shoulder. In areas farther from the road, which may be mown only once each year, or in hard to mow areas, such as around sign posts, the wildflower component will become dominant. Along cuts and side slopes which may never be mown, the shrub component will add diversity and beauty to the roadside plantings. It is a particularly appropriate seed mix for roadsides, industrial sites, or cut and fill slopes. These mixes may be applied by hydroseeding, or by mechanical spreader. Always apply on a clean, weed-free seed bed. After sowing, lightly rake or roll the site to improve seed-to-soil contact. Best results are obtained with a mid-late spring seeding. Summer seeding will benefit from a light mulching of clean, weed-free straw to conserve soil moisture.

New England Wetland Plants, Inc. may modify seed mixes at any time depending upon seed availability. The design criteria and ecological function of the mix will remain unchanged. Price is \$/bulk pound, FOB warehouse, Plus SH and applicable taxes.

# **NEW ENGLAND WETLAND PLANTS, INC**

820 WEST STREET, AMHERST, MA 01002

PHONE: 413-548-8000 FAX 413-549-4000

EMAIL: INFO@NEWP.COM WEB ADDRESS: WWW.NEWP.COM

## **New England Roadside Matrix Wet Meadow Seed Mix**

<b>Botanical Name</b>	<b>Common Name</b>	<b>Indicator</b>
<i>Elymus riparius</i>	Riverbank Wild Rye	FACW
<i>Elymus virginicus</i>	Virginia Wild Rye	FACW-
<i>Festuca rubra</i>	Red Fescue	FACU
<i>Panicum virgatum</i>	Switch Grass	FAC
<i>Carex scoparia</i>	Blunt Broom Sedge	FACW
<i>Cornus amomum</i>	Silky Dogwood	FACW
<i>Carex lurida</i>	Lurid Sedge	OBL
<i>Iris versicolor</i>	Blue Flag	OBL
<i>Asclepias incarnata</i>	Swamp Milkweed	OBL
<i>Viburnum dentatum</i>	Arrow Wood Viburnum	FAC
<i>Aster novae-angliae (Symphyotrichum novae-anglia</i>	New England Aster	FACW-
<i>Eupatorium perfoliatum</i>	Boneset	FACW
<i>Eupatorium maculatum (Eutrochium maculatum)</i>	Spotted Joe Pye Weed	OBL
<i>Sambucus canadensis</i>	Elderberry	FACW-
<i>Scirpus atrovirens</i>	Green Bulrush	OBL
<i>Aster umbellatus (Doellingeria u.)</i>	Flat Topped/Umbrella Aster	FACW

PRICE PER LB. \$65.00 MIN. QUANTITY 1 LBS. **TOTAL:** \$65.00 APPLY: 35 LBS/ACRE :1250 sq ft/lb

The New England Roadside Matrix Mixes are designed for use along roads and highways. These mixes are unusual in that they contain native grasses, wildflowers, and shrubs that are blended together as a native matrix seed mix. In areas that receive frequent mowing, the cold season grasses will dominate, such as those areas closest to the roadway shoulder. In areas farther from the road, which may be mown only once each year, or in hard to mow areas, such as around sign posts, the wildflower component will become dominant. Along cuts and side slopes which may never be mown, the shrub component will add diversity and beauty to the roadside plantings. It is a particularly appropriate seed mix for roadsides, industrial sites, or cut and fill slopes. These mixes may be applied by hydroseeding, or by mechanical spreader. Always apply on a clean, weed-free seed bed. After sowing, lightly rake or roll the site to improve seed-to-soil contact. Best results are obtained with a mid-late spring seeding. Summer seeding will benefit from a light mulching of clean, weed-free straw to conserve soil moisture.

New England Wetland Plants, Inc. may modify seed mixes at any time depending upon seed availability. The design criteria and ecological function of the mix will remain unchanged. Price is \$/bulk pound, FOB warehouse, Plus SH and applicable taxes.