

# PROPOSED WETLAND MITIGATION PLAN

By: REMA Ecological Services, LLC

Date: 12/18/2023 (revised)

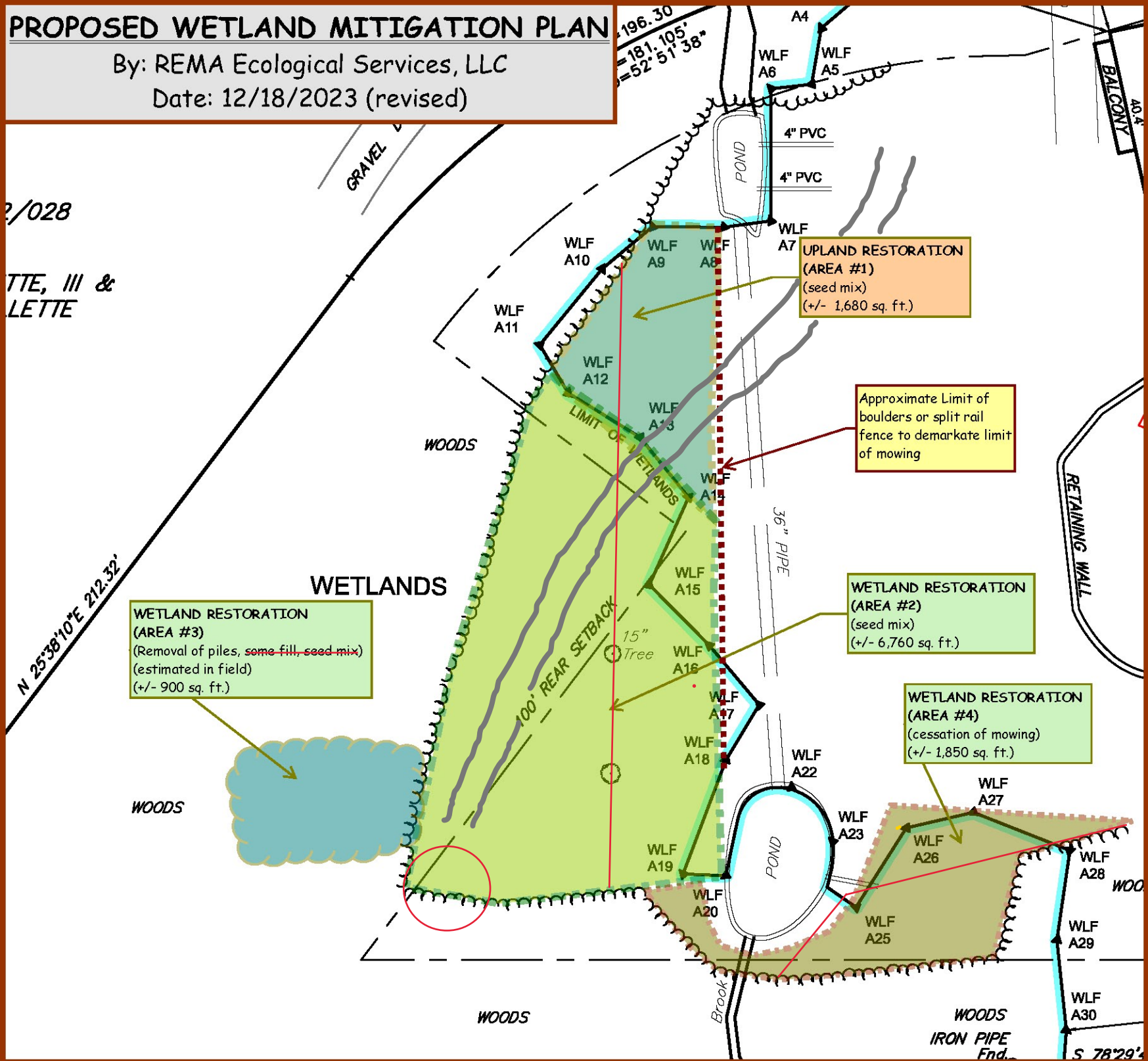

## MITIGATION IMPLEMENTATION NOTES:

1. The New England Roadside Matrix Upland Seed Mix shall be used for upland restoration.
2. The New England Roadside Matrix Wet Meadow Seed Mix shall be used for wetland restoration
3. Prior to seeding the planting medium in Areas #1 and #2, shall be prepared by tilling the lawn areas to a depth of 6 to 8 inches (e.g., roto-tilling)
4. The planting bed shall be fertilized (e.g., Milorgonite) and pH adjusted to 6.8 - 7.2 by liming.
5. Seed shall be applied with a nurse crop, at 10% by weight, such annual ryegrass.
6. The seeded areas shall be watered and covered with a thin layer of weed free straw.
7. In the late fall seeding can take place after the first hard frost or in mid- to late April.
8. In rear wooded portion of the property approximately 10-inches, on average, of deposited sandy material shall be removed (i.e., Wetland Restoration Area #3) and seeded with the wetland seed mix
9. Inspection/Monitoring shall take place for two years after implementation with memo to Town staff.
10. Removal of invasive plants shall take place during the 2-year monitoring period.