

LOCATION MAP
SCALE: 1"=1000'±

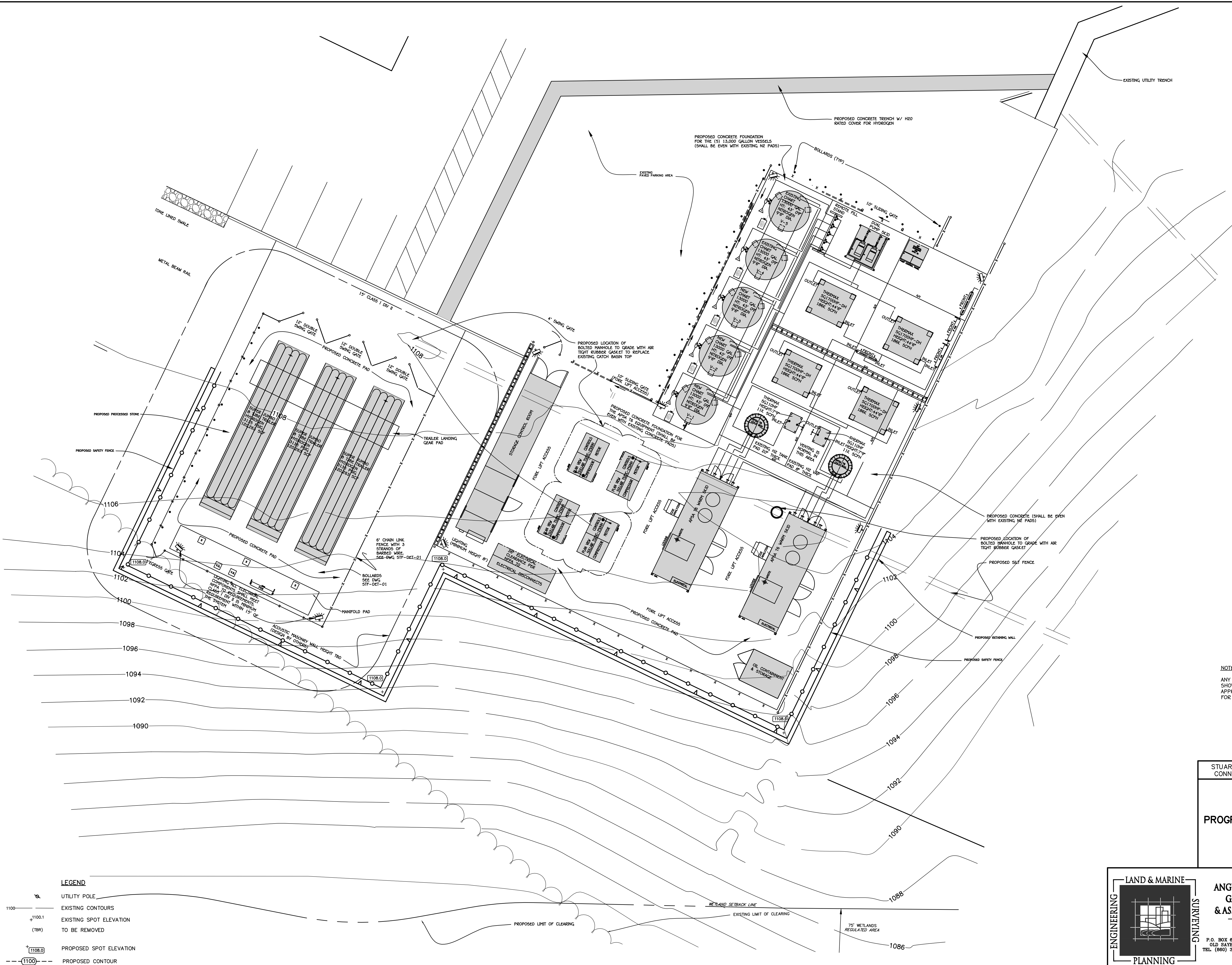

NOTE
ANY MODIFICATIONS TO THE LOCATION OR ELEVATION OF THE SEPTIC SYSTEM COMPONENTS SHOWN HEREON (INCLUDING CURTAIN DRAINS IF SHOWN) ARE SUBJECT TO THE WRITTEN APPROVAL OF THE DESIGN ENGINEER. THE DESIGN ENGINEER WILL NOT BE RESPONSIBLE FOR ANY CHANGES MADE WITHOUT SUCH WRITTEN APPROVAL.

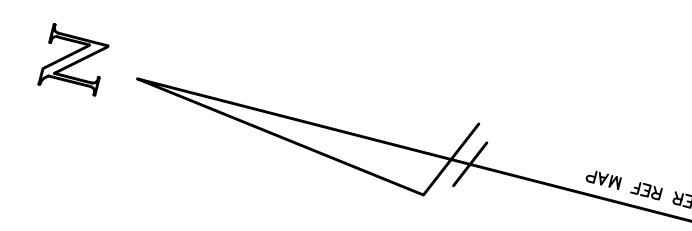

LEGEND

○	UTILITY POLE
—	EXISTING CONTOURS
±1100.1	EXISTING SPOT ELEVATION TO BE REMOVED
±1108.0	PROPOSED SPOT ELEVATION
- - -	PROPOSED CONTOUR

STUART J. FAIRBANK CONN. P.E. #20206	BOUNDARY LINES OF ADJOINING PROPERTIES ARE SHOWN FOR GENERAL INFORMATIONAL PURPOSES ONLY AND ARE NOT TO BE CONSTRUED AS BEING ACCURATELY LOCATED OR DEPICTED.
PROGRESS PRINT	©2022 - ANGUS McDONALD / GARY SHARPE & ASSOCIATES, INC. THESE DRAWINGS ARE THE PROPERTY OF ANGUS McDONALD/GARY SHARPE & ASSOCIATES, INC. AND HAVE BEEN SPECIFICALLY PREPARED FOR THE OWNER OF THIS PROJECT OR PROPERTY. THEY ARE NOT TO BE DUPLICATED OR USED IN PART OR WHOLE FOR ANY OTHER PURPOSE, PROJECT, LOCATION OR OWNER WITHOUT THE EXPRESS WRITTEN CONSENT OF ANGUS McDONALD/GARY SHARPE & ASSOCIATES, INC.
	THE WORD "CERTIFY", AS USED IS UNDERSTOOD TO BE AN EXPRESSION OF PROFESSIONAL OPINION BY THE ENGINEER OR SURVEYOR. IT IS A DECLARATORY STATEMENT WHICH IS BASED ON HIS BEST KNOWLEDGE, INFORMATION AND BELIEF. AS SUCH IT CONSTITUTES NEITHER GUARANTEE NOR WARRANTY, EXPRESSED OR IMPLIED, OF ANY INFORMATION CONTAINED HEREON. NO CERTIFICATION IS EXPRESSED OR IMPLIED ON ANY ORIGINAL OR ANY DUPLICATE OF THIS PLAN UNLESS IT BEARS AN ORIGINAL STAMP OR SEAL AND ORIGINAL SIGNATURE OF THE INDIVIDUAL WHOSE REGISTRATION NUMBER APPEARS HEREON.

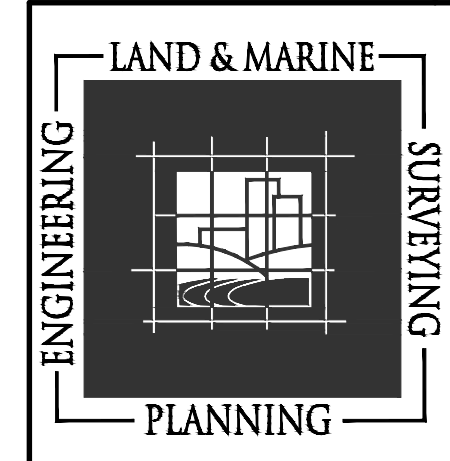

**ANGUS McDONALD
GARY SHARPE
& ASSOCIATES, INC.**
SINCE 1966
P.O. BOX 608, 233 BOSTON POST ROAD
OLD SAYBROOK, CONNECTICUT 06475
TEL. (860) 388-4871 FAX (860) 388-3982

UTILITY PLAN	
PREPARED FOR	
TPR ASSOCIATES LLC	
539 TECHNOLOGY PARK DRIVE TORRINGTON, CONNECTICUT	
DATE: OCTOBER 24, 2022	SCALE: 1"=10'
DR'N MCM	CHK'D APP'D
SHEET 3 of 3	JOB NO. 216579
REVISIONS:	