

VICINITY MAP
SCALE: 1"=1000'±

MAP REFERENCES

1. Refer to map entitled "PROPERTY OF, 601 SOUTH MAIN STREET, SOUTH MAIN STREET & PALMER BRIDGE STREET, TORRINGTON, CONNECTICUT", scale: 1"=20', dated October, 1989, prepared by Robert C. Sterling, Land Surveyor.
2. Refer to map entitled "SUB-DIVISION OF THE BROOK-SIDE VIEW TRACT OF LAND, OWNED BY THE, NEW ENGLAND DEVELOPMENT AND IMPROVEMENT COMPANY, AT TORRINGTON, CONN.", scale: 50"=1", dated April 30, 1897, prepared by W.M.P. Shelton, C.E. Map #23.
3. Refer to map entitled "SURVEY, PROPERTY OF, GEORGE M. SABOLCIK, SOUTH MAIN STREET, TORRINGTON, CONNECTICUT", scale: 1"=20', dated Feb. 15, 1978, prepared by Arthur F. Hoffman Land Surveyor. Map #2091 T.L.R.
4. Refer to map entitled "CONNECTICUT STATE HIGHWAY DEPARTMENT, RIGHT OF WAY MAP, TOWN OF TORRINGTON, SOUTH MAIN STREET, FROM GULF STREAM SOUTHERLY ABOUT 3,500 FEET, ROUTE No.8." scale: 1"=40', dated Jan. 31, 1939, Number 143-12, sheet 1 of 2 & 2 of 2.
5. Refer to map entitled "LAYOUT OF PALMER BRIDGE ST., CITY OF TORRINGTON, ENGINEERING DEPT.", scale: 1"=40', dated Oct. 1928, C.A. Miller City Eng'r.

NOTES

1. This survey and map has been prepared in accordance with Sections 20-300b-1 thru 20-300b-20 of the Regulations of Connecticut State Agencies - "Minimum Standards for Surveys and Maps in the State of Connecticut" as endorsed by the Connecticut Association of Land Surveyors, Inc. It is a LIMITED PROPERTY SURVEY based on a RESURVEY and conforms to a Horizontal Accuracy Class A-2.
2. OWNER OF RECORD - 601 SOUTH MAIN STREET, LLC. (Vol.1217-Pg.1117)
3. AREA - 24,434 S.F. or 0.538 Acres.
4. ASSESSOR PARCEL #115/020/010
5. ZONE - R6
6. Not all improvements shown.

ZONING LOCATION SURVEY

PREPARED TO SHOW
**PARCEL PROPOSED
 TO BE CHANGED FROM ZONE R-6
 TO ZONE LOCAL BUSINESS**
 SOUTH MAIN STREET & PALMER BRIDGE STREET
 TORRINGTON, CONNECTICUT

SCALE: 1"=20'	DATE JUNE, 2022	SHEET NO. 1 OF 1	JOB NO. 0324-102
------------------	--------------------	---------------------	---------------------

Timothy G. Wyllie Jr., Land Surveyor
 Barkhamsted, Connecticut
 Phone: 860.605.9075 email: tgwsurveying@gmail.com

TO MY KNOWLEDGE AND BELIEF, THIS MAP IS SUBSTANTIALLY CORRECT AS NOTED HEREON.

TIMOTHY G. WYLLIE, JR. LICENSE # 70421 L.S.
 NOT VALID UNLESS EMBOSSED SEAL IS AFFIXED

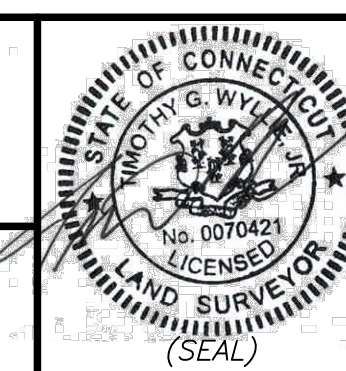
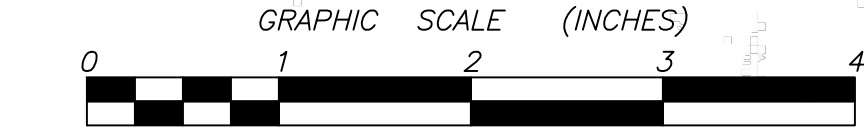

NO.	REVISIONS